

# Exhibit C

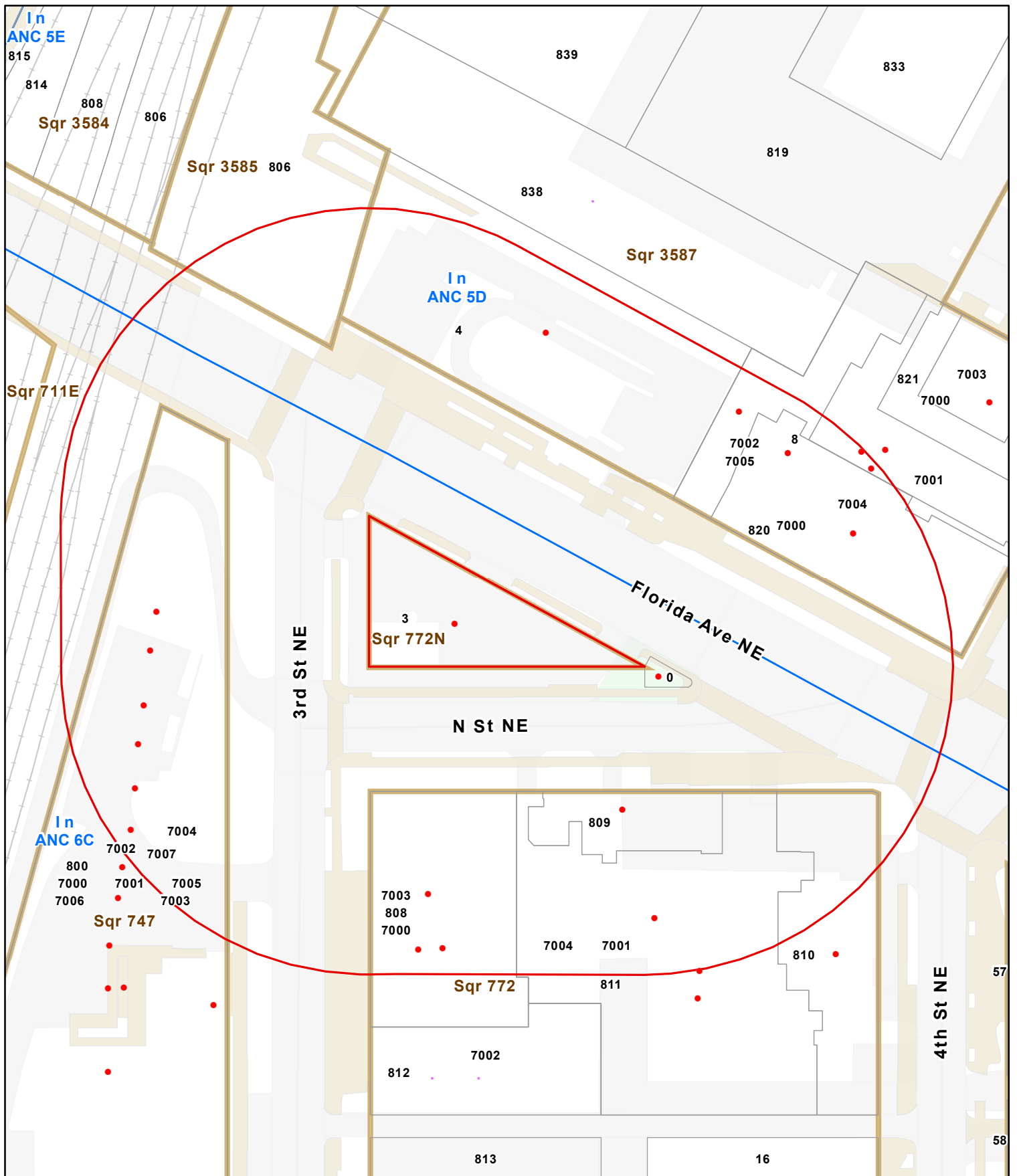

**Subject Property ID(s):**  
**0772 003**

- Subject Property
- Radius
- Ownership Lots
- DC Squares
- ANC Boundary

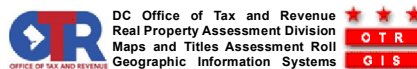

1:1,000  
 0 50  
 Feet

Print Date: 10/13/2021

For general planning purposes

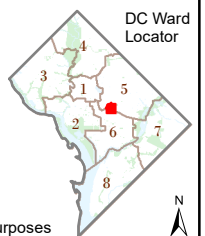

ZS 2607 LLC  
151 HAVEN AVE  
PORT WASHINGTON NY 11050-3926

GATEWAY MARKET LLC  
1221 MAIN ST STE 1000  
COLUMBIA SC 29201-3255

GATEWAY MARKET L/ CAL LLC  
2 BETHESDA METRO CTR STE 800  
BETHESDA MD 20814-5395

ARMATURE WORKS (RESIDENTIAL)  
OWNER LLC  
1055 THOMAS JEFFERSON STREET NW  
SUITE 600  
WASHINGTON DC 2007-5258

320 FLORIDA OWNER LLC  
1875 CONNECTICUT AVE NW FL 10  
WASHINGTON DC 20009-5728

331 N JUST LLC  
12435 PARK POTOMAC AVE STE 200  
POTOMAC MD 20854-6975

DISTRICT OF COLUMBIA  
2000 14TH ST NW 8TH FLOOR  
WASHINGTON DC 20009-4487

GATEWAY MARKET (SOE) LLC  
PO BOX 528  
COLUMBIA SC 29202-0528

301 N STREET TITLEHOLDER  
12435 PARK POTOMAC AVE STE 200  
POTOMAC MD 20854-6975